



Space-Ray

PO Box 36485, Charlotte,
NC 28236-6485
Tel: 704 372 3485
e-mail: info@spaceray.com

Air Switch Retrofit Kit Instructions

(models RSTP10 & RSTP17)

⚠ WARNING



ELECTRIC SHOCK HAZARD

Disconnect electrical supply before servicing

Failure to follow these instructions may result in death, serious injury or property damage.

Kit Contents Kit No: 42837000

| Item No | Part No | Description | Qty |
|---------|-----------|-----------------------------------|-----|
| 1 | 42840050 | Air Switch and Brkt. Assembly | 1 |
| 2 | 42742980 | Air Sensing Tube and Mtg. Brkt. | 1 |
| 3 | *03988070 | Silicone Tubing - 7" Lg. | 1 |
| 4 | 02261000 | Self-Tapping Screw #8-32 x 3/8" | 1 |
| 5 | 03139000 | 1/4" Wire Terminals | 2 |
| 6 | 02166010 | Pan HD Machine Screw #8-32 x 3/8" | 1 |
| 7 | 02167040 | Locknut #8-32 | 1 |
| 8 | 42838000 | Form, Installation (not shown) | 1 |

***Notes:**

1. Shorten silicone tube to prevent any sagging.
2. Discard any extra fasteners and components not required for each retrofit.

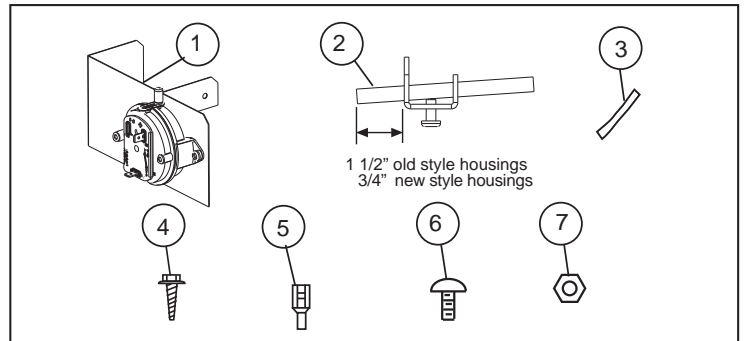

ASSEMBLY INSTRUCTIONS

Sail Switch to Air Switch Retrofit

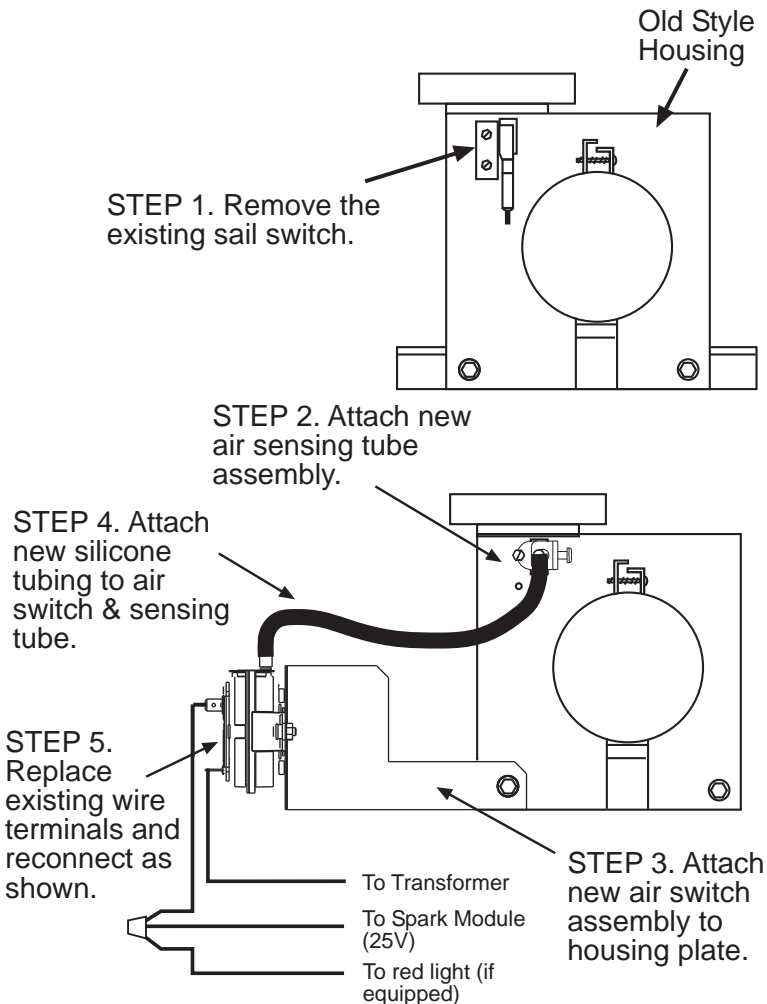

Air Switch to Air Switch Retrofit

